



4680 Vinita Court  
Chino, CA 91710

# "FD8 SERIES" DEADBOLT with an "F SERIES" LEVER or KNOB

in a  
**STEEL DOOR**  
INSWING / OUTSWING  
**"IMPACT"**

GENERAL NOTES

1. This product has been evaluated and is in compliance with the 6th Edition (2017) Florida Building Code (FBC) structural requirements excluding the "High Velocity Hurricane Zone" (HVHZ).
2. Product anchors shall be as listed and spaced as shown on details. Anchor embedment to base material shall be beyond wall dressing or stucco. Anchors shown are for the door components only. Refer to the current Florida Statewide product approval for the anchoring of the door system to the substrate.
3. When used in areas requiring wind borne debris protection this product complies with FBC Sections 1609.1.2 & R301.2.1.2 and does not require an impact resistant covering. This product meets missile level "D" and includes Wind Zone 4 as defined in ASTM E 1996 and FBC Sections 1609.1.2.2 & R301.2.1.2.1.
4. This product has been tested in the door panels as specified in this approval. Substitution into a similar product may be approved for use by the local Authority Having Jurisdiction. In all cases, the steel door used must possess a comparable current Florida Statewide product approval w/ installation instructions. The door panel size and design pressure (DP) rating shall not exceed the sizes and DP ratings shown in this approval or the steel side hinged swing door approval being used.
5. Site conditions that deviate from the details of this drawing require further engineering analysis by a licensed engineer or registered architect.

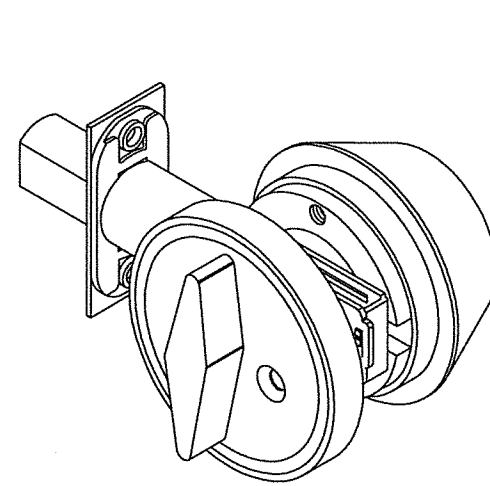

"FD8 Series" Deadbolt

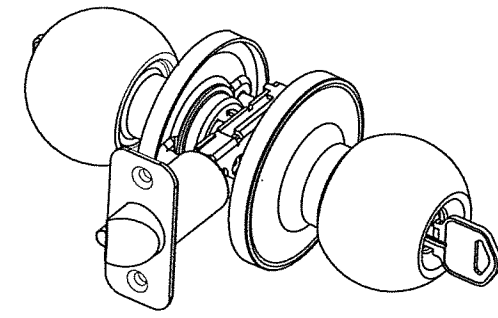

"F Series" Knob

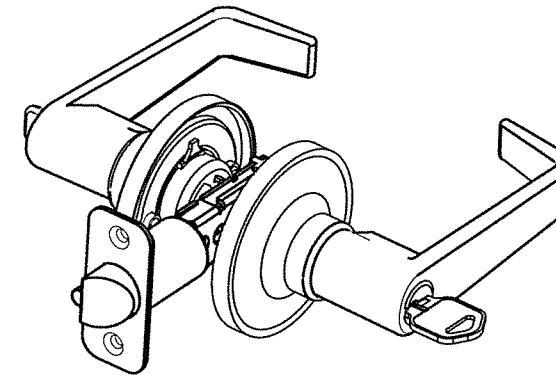

"F Series" Lever

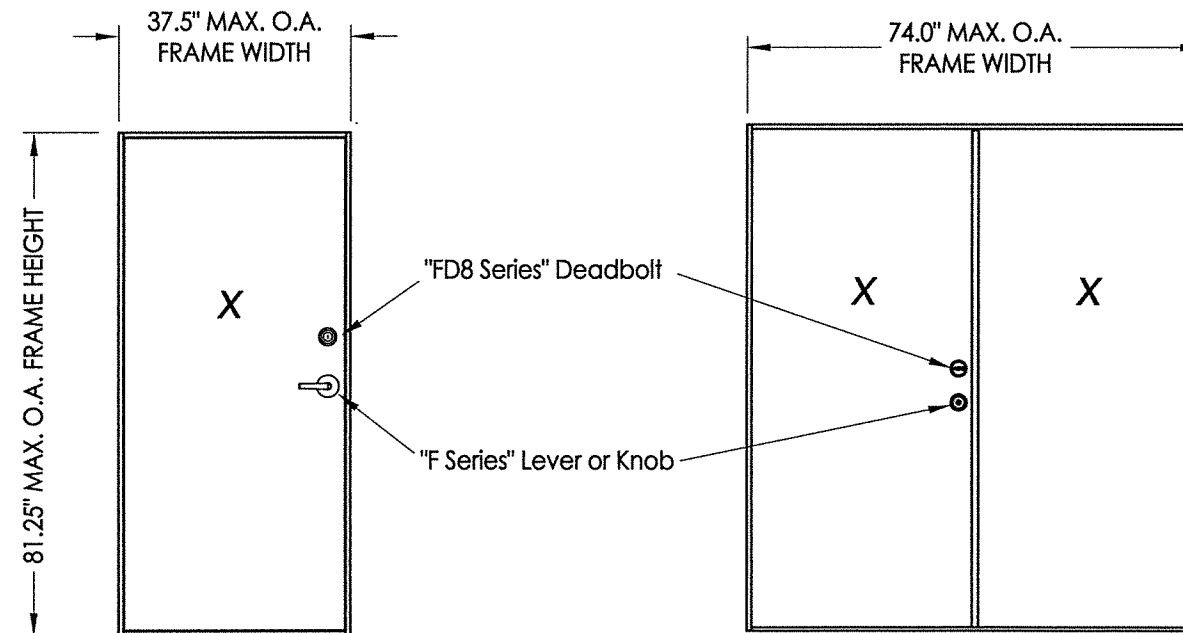

CONFIGURATION	MAX FRAME DIMENSION	LOCK & DEADBOLT TYPE	DESIGN PRESSURE (PSF) INSWING / OUTSWING	
			POSITIVE	NEGATIVE
SINGLE (opaque)	37.5" x 81.25"	"FD8 Series" Deadbolt with a	+65.0	-70.0
SINGLE (glazed) DOUBLE (opaque / glazed)	74.5" x 81.25"	"F Series" Lever or Knob (PAMEX)	+45.0	-50.0

TABLE OF CONTENTS	
SHEET#	DESCRIPTION
1	Typical elevation, design pressures & general notes
2	"FD8 Series" deadbolt & installation details
3	"F Series" knob & lever details
4	Steel door panel details

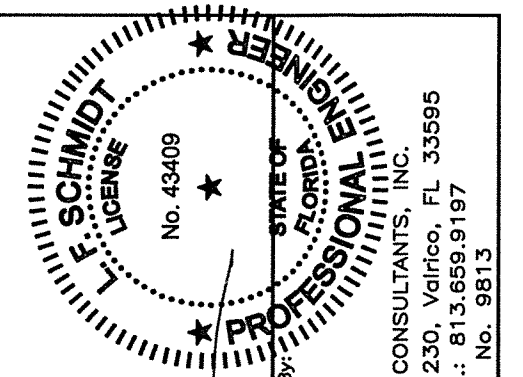

Documents Prepared By:  
Lyndon F. Schmidt  
P.E. No. 43409

*RW* BUILDING CONSULTANTS, INC.  
P.O. Box 230, Valrico, FL 33595  
Phone No.: 813.659.9197  
FBPE C.A. No. 9813

PRODUCT: PAMEX LOCK AND DEADBOLT  
PART OR ASSEMBLY: TYPICAL ELEVATION, DESIGN PRESSURES & GENERAL NOTES

NO.	DATE	REVISIONS
3	10/03/17	UPDATE TO 6TH ED. (2017) FBC LFS JK
2	3/27/15	UPDATE TO 5TH ED. (2014) FBC JK
1	4/24/12	UPDATE TO 2010 FBC JK

DATE: 8/01/11  
SCALE: N.T.S.  
DWG. BY: JK  
CHK. BY: LFS  
DRAWING NO.: FL-14722.2  
SHEET 1 OF 4

**"FD8 SERIES" DEADBOLT DETAILS**

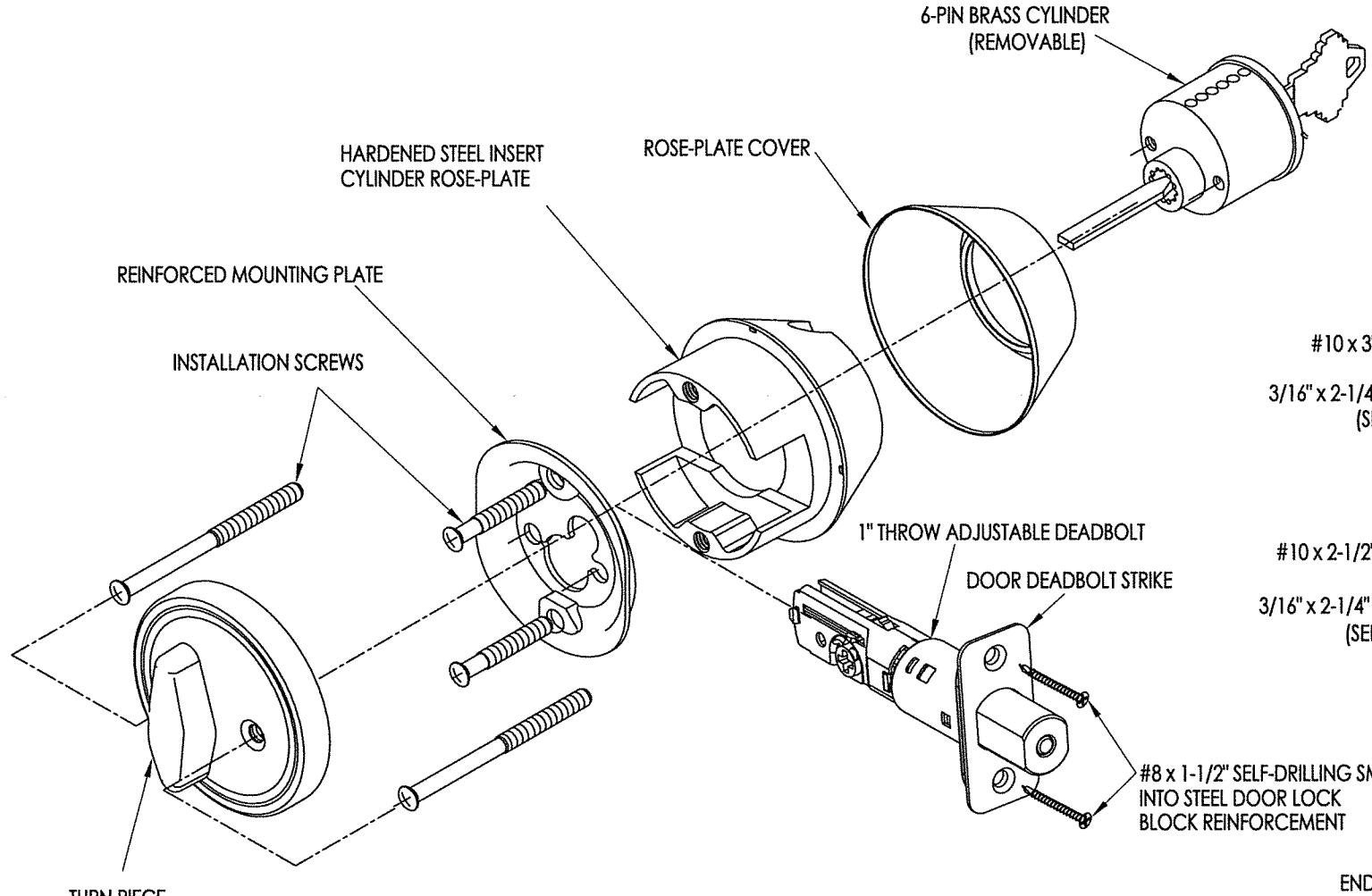

**SINGLE DOOR WOOD FRAME INSTALLATION DETAILS**

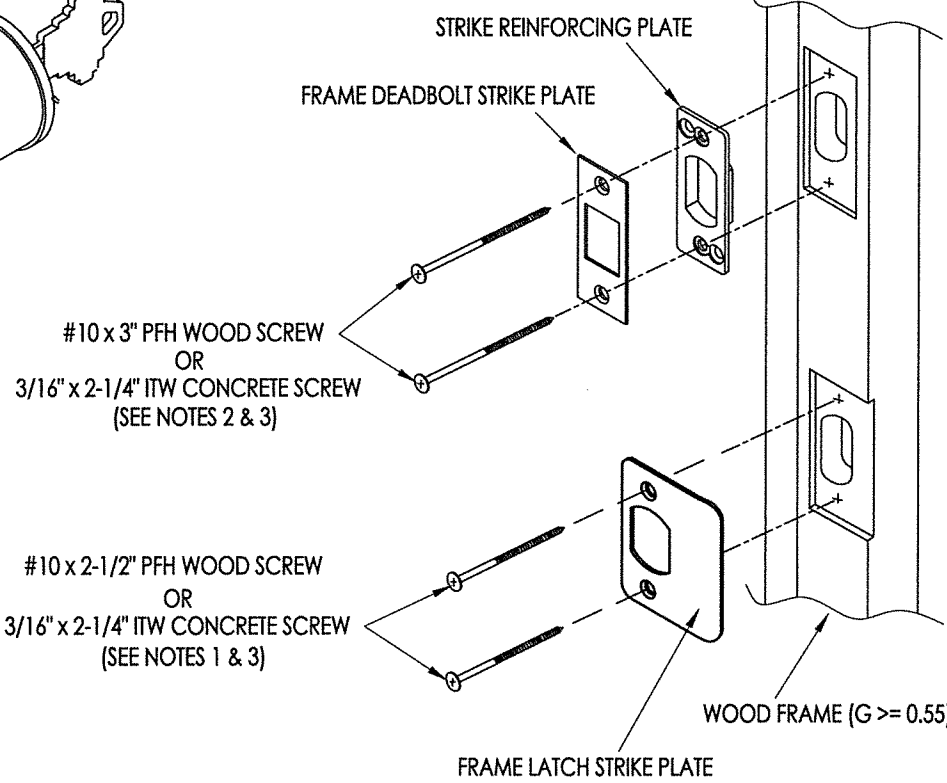

**DOUBLE DOOR INSTALLATION DETAILS**

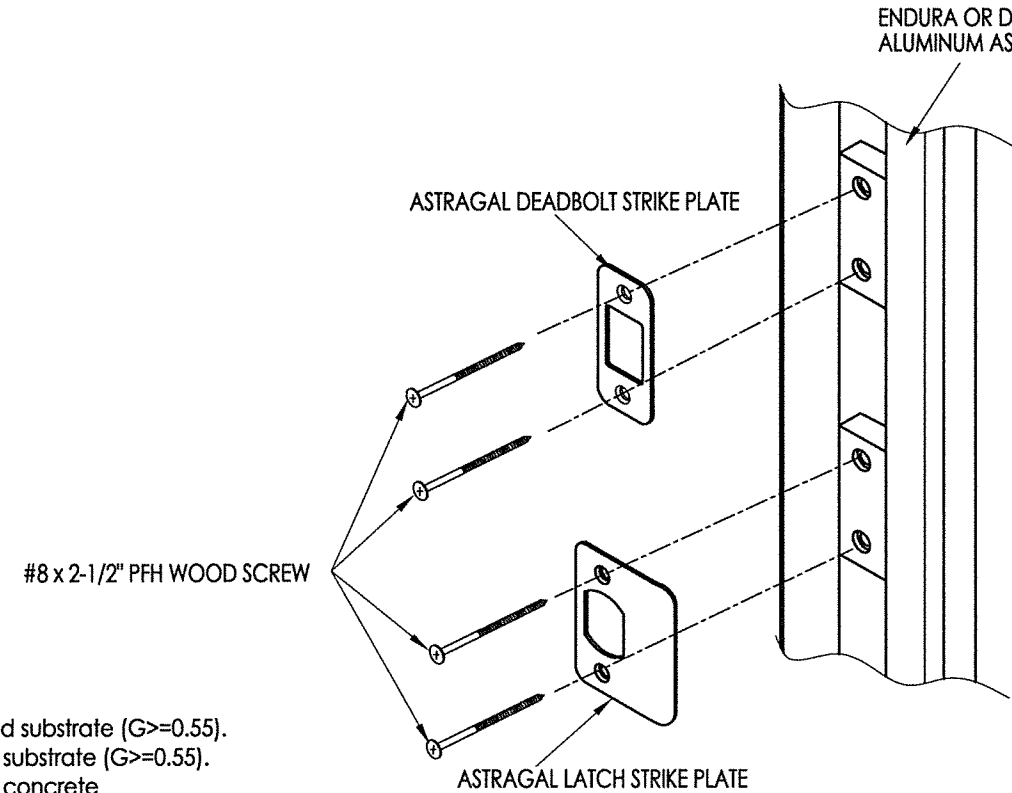

**SINGLE DOOR STEEL FRAME INSTALLATION DETAILS**

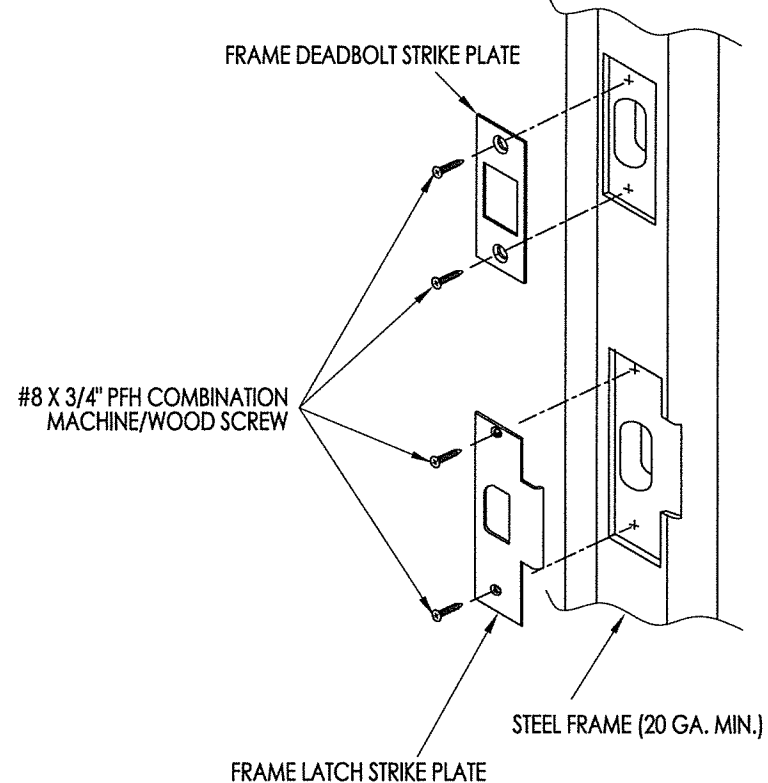

- NOTES :**
1. Wood screw installation requires 1.5" min. embedment into wood substrate (G>=0.55).
  2. Wood screw installation requires 2" min. embedment into wood substrate (G>=0.55).
  3. Concrete screw installation requires 1.25" min. embedment into concrete (conforming to ACI 301, 3000 psi min.) or hollow block (conforming to ASTM C-90) and maintaining a min. 3" edge distance and 1-1/2" min. center-to-center spacing of anchors.

Lyndon F. Schmidt  
 P.E. No. 43409

BUILDING CONSULTANTS, INC.  
 P.O. Box 230, Valrico, FL 33595  
 Phone No.: 813.659.9197  
 FBPE C.A. No. 9813

PRODUCT:		PAMEX	
		LOCK AND DEADBOLT	
PART OR ASSEMBLY:		"FD8 SERIES" DEADBOLT & INSTALLATION DETAILS	
NO.	DATE	BY	REVISIONS
3	10/03/17	LFS	UPDATE TO 6TH ED. (2017)
2	3/18/15	JK	UPDATE TO 5TH ED. (2014)
1	4/24/12	JK	UPDATE TO 2010 FBC
DATE: 8/01/11			
SCALE: N.T.S.			
DWG. BY: JK			
CHK. BY: LFS			
DRAWING NO.: FL-14722.2			
SHEET 2 OF 4			

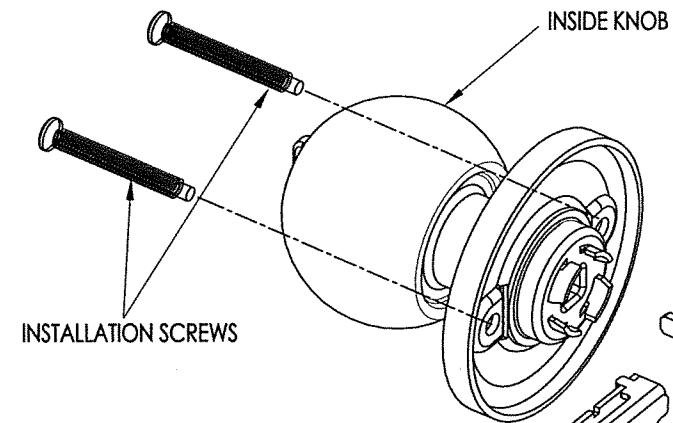

INSTALLATION SCREWS

INSIDE KNOB

FACEPLATE

5-PIN OR 6-PIN BRASS CYLINDER

#8 x 1-1/2" SELF-DRILLING SMS INTO STEEL DOOR LOCK BLOCK REINFORCEMENT

DOOR LATCH STRIKE

1/2" THROW ADJUSTABLE LATCH

OUTSIDE KNOB ASS'Y

**"F SERIES" KNOB DETAILS**

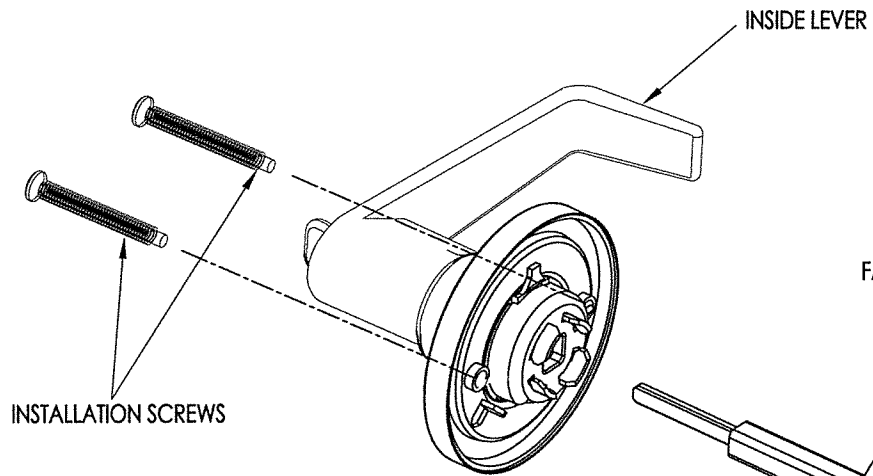

INSTALLATION SCREWS

INSIDE LEVER

OUTSIDE LEVER ASS'Y

FACEPLATE

5-PIN OR 6-PIN BRASS CYLINDER

#8 x 1-1/2" SELF-DRILLING SMS INTO STEEL DOOR LOCK BLOCK REINFORCEMENT

DOOR LATCH STRIKE

1/2" THROW ADJUSTABLE LATCH

**"F SERIES" LEVER DETAILS**

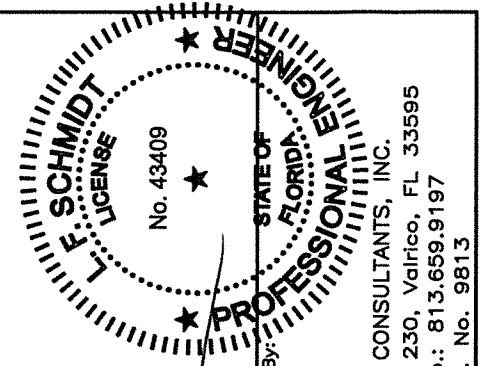

Documents Prepared By:  
Lyndon F. Schmidt  
P.E. No. 43409

**RW**  
BUILDING CONSULTANTS, INC.  
P.O. Box 230, Valrico, FL 33595  
Phone No.: 813.659.9197  
FBPE C.A. No. 9813

PRODUCT:	PAMEX
	LOCK AND DEADBOLT
PART OR ASSEMBLY:	"F SERIES" KNOB & LEVER DETAILS

NO.	DATE	BY	REVISIONS
3	10/03/17	LFS	UPDATE TO 6TH ED. (2017) FBC
2	3/18/15	JK	UPDATE TO 5TH ED. (2014) FBC
1	4/24/12	JK	UPDATE TO 2010 FBC

DATE:	8/01/11
SCALE:	N.T.S.
DWG. BY:	JK
CHK. BY:	LFS
DRAWING NO.:	FL-14722.2
SHEET	3 OF 4

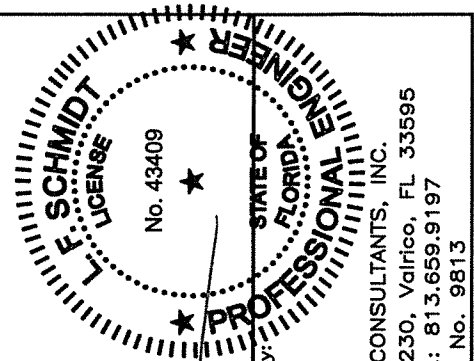
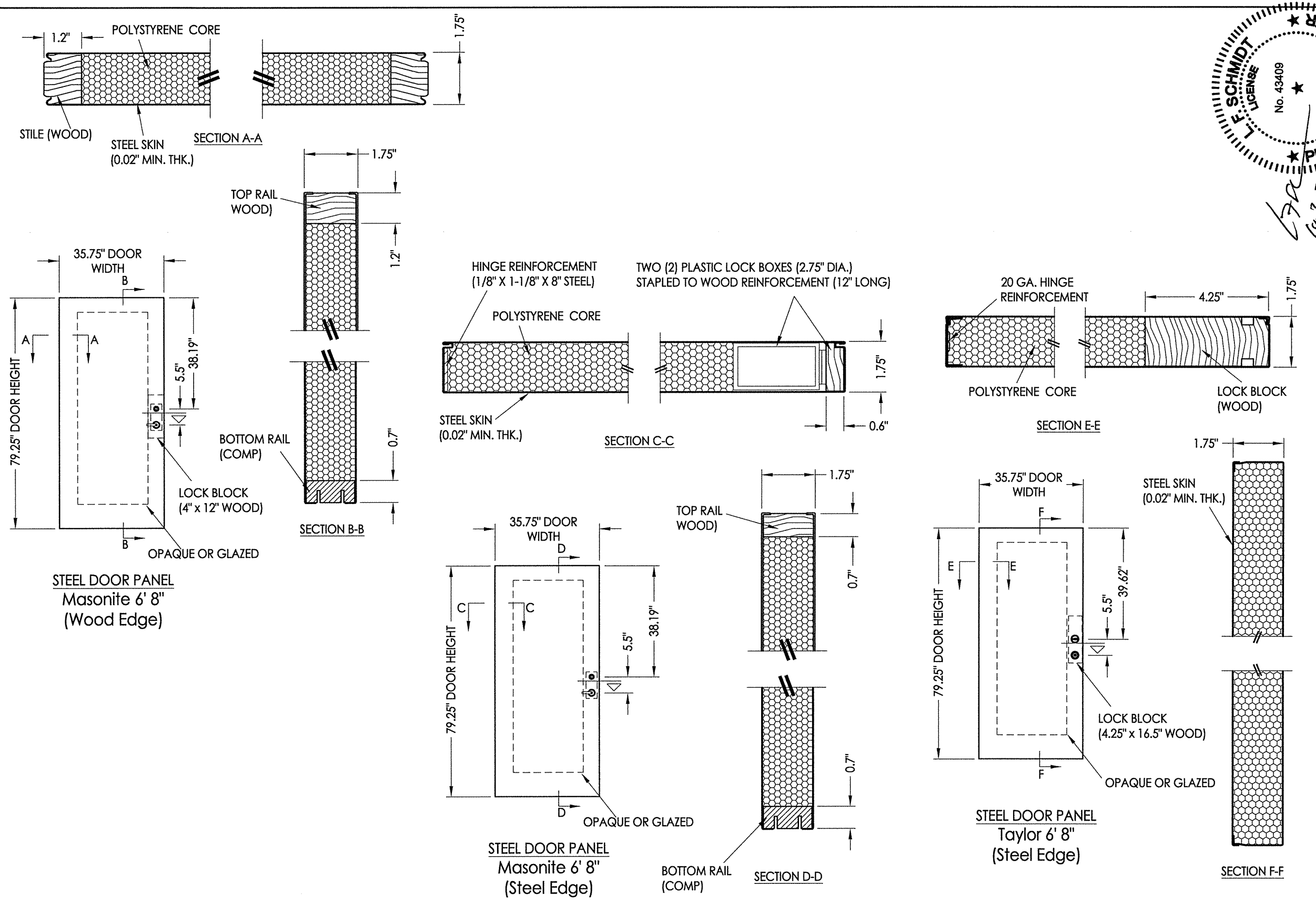

Documents Prepared By:  
 Lyndon F. Schmidt  
 P.E. No. 43409

**RW**  
 BUILDING CONSULTANTS, INC.  
 P.O. Box 230, Vairco, FL 33595  
 Phone No.: 813.659.9197  
 FBPE C.A. No. 9813

PRODUCT: PAMEX LOCK AND DEADBOLT  
 PART OR ASSEMBLY: STEEL DOOR PANEL DETAILS

NO.	DATE	REVISIONS
3	10/03/17	UPDATE TO 6TH ED. (2017) FBC LFS
2	3/27/15	UPDATE TO 5TH ED. (2014) FBC JK
1	4/24/12	UPDATE TO 2010 FBC JK

DATE: 8/01/11  
 SCALE: N.T.S.  
 DWG. BY: JK  
 CHK. BY: LFS  
 DRAWING NO.: FL-14722.2  
 SHEET 4 OF 4